



CITY OF NAPOLEON  
ENGINEERING DEPARTMENT

255 W. Riverview Avenue, PO Box 151, Napoleon, OH 43545  
Phone: 419-592-4010 - Fax: 419-599-8393

**Mayor**

J. Andrew Small

**Members of Council**

Glenn A. Miller, President

Terri A. Williams

James Hershberger

Travis B. Sheaffer

John A. Helberg

Steven C. Small

Michael J. DeWit

4/17/2008

Wood County Building Inspection Department  
1 Courthouse Square  
Bowling Green, OH 43402

RE: 1515 Scott St.

**City Manager**

Dr. Jon A. Bisher

To Whom It May Concern:

**City Finance Director**

Gregory J. Heath

No zoning permit is required for the referenced property.

Sincerely,

**City Law Director**

David M. Grahn

Tom Zimmerman  
Building/Zoning Inspector

**City Engineer**

Chad E. Lulfs, P.S., P.E.

TZ:as

**City Building &  
Zoning Inspector**

Tom Zimmerman

cc:

**Zoning Permit Only!**  
other permits may be required



**SITE LICENSE APPLICATION**



ACCOUNT MANAGER	<u>Susan Ross</u>	PHONE NUMBER	<u>513-677-8750</u>
OPS CONTACT	<u>Troy Siebenaler</u>	PHONE NUMBER	<u>260-479-8093</u>
DATE OF SUBMITTAL	<u>3-Mar-08</u>	SPECIAL PROJECT	

**SITE INFORMATION**

ATC SITE NAME	<u>Maumee River</u>	ATC SITE NUMBER	<u>99044</u>
CUSTOMER SITE NAME	<u>Maumee River</u>	CUSTOMER SITE NUMBER	<u>BR444972</u>
ADDRESS	<u>1515 N Scott Street</u>		
CITY	<u>Napoleon</u>	COUNTY	<u>Henry</u>
STATE	<u>OH</u>	ZIP	<u>43545</u>
LATTITUDE (dgs-min-sec)	<u>41-24-15.31</u>	LONGITUDE (dgs-min-sec)	<u>84-8-10.05</u>
ATC CUSTOMER NUMBER			

**CUSTOMER CONTACT INFORMATION**

CUSTOMER NAME (PARENT COMPANY)	<u>Bright Personal Communications, Inc., an Ohio Corporation</u>	STATE OF INCORPORATION	<u>Ohio</u>
COLO PACKAGE NOTIFICATION ADDRESS	<u>648 N Chicago St</u>	ATTN	<u>Nathan Olson</u>
CITY	<u>Geneseo</u>		
STATE	<u>IL</u>	ZIP	<u>61254</u>

**FIRM OR CONTACT NAME      TELEPHONE      FAX      E-MAIL**

RF ENGINEER	<u>Dave Kiechle</u>	<u>(616) 656-5162</u>	<u>(616) 554-6484</u>	<u>dkiechle@ilpcs.com</u>
CONSTRUCTION ENGINEER	<u>Randy Blecha</u>	<u>(616) 633-9738</u>	<u>(616) 55406484</u>	<u>rblecha@ilpcs.com</u>
REAL ESTATE/SITE ACQ	<u>Nathan Olson</u>	<u>616-656-5161</u>	<u>616-554-6484</u>	<u>nolson@ilpcs.com</u>
INSTALLATION CONTRACTOR	<u>TBD</u>	<u>N/A</u>	<u>N/A</u>	<u>N/A</u>
ACCOUNTS PAYABLE	<u>Shelby Padenz</u>	<u>309-945-4219</u>	<u>309-945-1651</u>	<u>shelby@ilpcs.com</u>
OTHER	<u>N/A</u>	<u>N/A</u>	<u>N/A</u>	<u>N/A</u>

**GROUND SPACE REQUIREMENTS**

LOCATION OF CUSTOMER EQUIPMENT	<input type="checkbox"/> INDOOR CABINETS (ATC Building)	<input type="checkbox"/> OUTDOOR SHELTER (Customer Building)	<input checked="" type="checkbox"/> BTS CABINET
# OF RACKS/CABINETS/BTS	<u>4</u>	SHELTER/CABINET/BTS DIMENSIONS (HxLxW) (ft)	<u>54.8" x 30" x 52"</u>
LEASED GROUND SPACE DIMENSIONS (HxLxW) (ft)	<u>150 Sq. Ft.</u>	CONCRETE PAD DIMENSIONS (L X W) (ft)	<u>9' x 16' Platform (144 Sq. Ft.)</u>
ADDITIONAL GROUND SPACE REQUIREMENTS FOR GENERATOR	<u>None</u>	POWER PROVIDED BY:	<input type="checkbox"/> ATC PROVIDED <input type="checkbox"/> UTILITY COMPANY DIRECT <input checked="" type="checkbox"/>
TELCO/INTERCONNECT REQUIREMENTS	<input type="checkbox"/> POTS <input type="checkbox"/> T1	<input checked="" type="checkbox"/> MICROWAVE	<input type="checkbox"/> FIBER OPTICS
GENERATOR INFORMATION	APPLICANT PROVIDED	<input type="checkbox"/> NONE <input checked="" type="checkbox"/>	
	MANUFACTURER	<u>N/A</u>	MAKE/ MODEL <u>N/A</u> CAPACITY (KW) <u>N/A</u>
	FUEL TYPE	<u>N/A</u>	TANK SIZE <u>N/A</u> BODY TYPE <u>N/A</u>

**BUILDING/SHELTER EQUIPMENT SPECIFICATIONS**

	TRANSMITTER #1	TRANSMITTER #2	TRANSMITTER #3	TRANSMITTER #4	TRANSMITTER #5	TRANSMITTER #6
MANUFACTURER	<u>Nortel</u>	<u>N/A</u>	<u>N/A</u>	<u>N/A</u>	<u>N/A</u>	<u>N/A</u>
TYPE & MODEL	<u>Compact metrocell</u>	<u>N/A</u>	<u>N/A</u>	<u>N/A</u>	<u>N/A</u>	<u>N/A</u>
TYPE of SERVICE	<u>PCS CDMA</u>	<u>N/A</u>	<u>N/A</u>	<u>N/A</u>	<u>N/A</u>	<u>N/A</u>
TX POWER OUTPUT	<u>25 Watt/Carrier</u>	<u>N/A</u>	<u>N/A</u>	<u>N/A</u>	<u>N/A</u>	<u>N/A</u>
ERP	<u>1640 Watts Per Channel</u>	<u>N/A</u>	<u>N/A</u>	<u>N/A</u>	<u>N/A</u>	<u>N/A</u>
AVERAGE MONTHLY POWER CONSUMPTION (If Applicable)	<u>N/A</u>	<u>N/A</u>	<u>N/A</u>	<u>N/A</u>	<u>N/A</u>	<u>N/A</u>
ELECTRIC SERVICE REQUIRED (Amps/Volts)	<u>200 Amps / 240 Volts</u>	<u>N/A</u>	<u>N/A</u>	<u>N/A</u>	<u>N/A</u>	<u>N/A</u>
COMBINER/# of PORTS (Applicable only if using Master Combining System)	<u>N/A</u>	<u>N/A</u>	<u>N/A</u>	<u>N/A</u>	<u>N/A</u>	<u>N/A</u>

ANTENNA EQUIPMENT SPECIFICATIONS						
	SECTOR #1	SECTOR #2	SECTOR #3	DISH	TTA/MHA	GPS
ANTENNA QUANTITY	2	2	2	N/A	N/A	N/A
INSTALLATION STATUS - Indicate either Existing, Removing, Proposed, or Never Installed	Proposed	Proposed	Proposed	N/A	N/A	N/A
TRANSMIT OR RECEIVE	TX/RX	TX/RX	TX/RX	N/A	N/A	N/A
MANUFACTURER	CSA	CSA	CSA	N/A	N/A	N/A
TYPES OF ANTENNAS	Panel	Panel	Panel	N/A	N/A	N/A
MODEL #	PCSA065-19-2	PCSA065-19-2	PCSA065-19-2	N/A	N/A	N/A
ANTENNA WEIGHT (Per Antenna)	24.6 lbs	24.6 lbs	24.6 lbs	N/A	N/A	N/A
ANTENNA DIMENSIONS (HxWxD) (Indicate feet or inches)	75" x 8.5" x 7.5"	75" x 8.5" x 7.5"	75" x 8.5" x 7.5"	N/A	N/A	N/A
ANTENNA MOUNT HEIGHT (ft)	170'	170'	170'	N/A	N/A	N/A
RAD CENTER AGL (ft)	170'	170'	170'	N/A	N/A	N/A
MOUNT TYPE (Flush, Platform, Pipe, T-frame, etc.)	Sector T-Mounts	Sector T-Mounts	Sector T-Mounts	N/A	N/A	N/A
TOWER LEG	N/A	N/A	N/A	N/A	N/A	N/A
DIRECTION of RADIATION	20°	160°	270°	N/A	N/A	N/A
TX FREQUENCY	1930-1990 MHz	1930-1990 MHz	1930-1990 MHz	N/A	N/A	N/A
RX FREQUENCY	1850-1910 MHz	1850-1910 MHz	1850-1910 MHz	N/A	N/A	N/A
ANTENNA GAIN	19.5 dBi (17.4 dBd)	19.5 dBi (17.4 dBd)	19.5 dBi (17.4 dBd)	N/A	N/A	N/A
# of LINES PER ANTENNA	1	1	1	N/A	N/A	N/A
LINE TYPE	Coax - Andrew	Coax - Andrew	Coax - Andrew	N/A	N/A	N/A
LINE DIAMETER	1.5/8"	1.5/8"	1.5/8"	N/A	N/A	N/A
Is equipment transmitting on unlicensed frequencies? (check box)	YES <input type="checkbox"/>	NO <input checked="" type="checkbox"/>				
FOR ATC USE -ACCOUNT MANAGER						
MLA RESERVATION	<input type="checkbox"/>	MLA LICENCE OR LEASE <input checked="" type="checkbox"/>	SLA <input type="checkbox"/>	AMENDMENT TO EXISTING LEASE <input type="checkbox"/>	REWRITE ON ATC PAPER <input type="checkbox"/>	BTS ANCHOR TENANT <input type="checkbox"/>
IS APPLICATION FEE REQUIRED?	YES <input type="checkbox"/>	NO <input checked="" type="checkbox"/>				
WILL ATC BE PERFORMING AZP WORK?	YES <input checked="" type="checkbox"/>	NO <input type="checkbox"/>	IF YES, AT WHAT COST?			
NOTES TO FEASIBILITY:	This is part of the iPCS project being run by Susan Stoker					
FOR ATC USE- FEASIBILITY						
IS THIS SITE SUBJECT TO RIGHT OF FIRST REFUSAL?	YES <input checked="" type="checkbox"/>	NO <input type="checkbox"/>				
IS THIS GROUND LEASE SUBJECT TO REVENUE SHARE?	YES <input type="checkbox"/>	NO <input checked="" type="checkbox"/>				
STRUCTURAL ANALYSIS	ATC REQUIRED <input checked="" type="checkbox"/>	NOT REQUIRED BY ATC <input type="checkbox"/>	PERFORMED AT CUSTOMER REQUEST <input type="checkbox"/>			
SSIS	ATC REQUIRED <input checked="" type="checkbox"/>	NOT REQUIRED BY ATC <input type="checkbox"/>	PERFORMED AT CUSTOMER REQUEST <input type="checkbox"/>			
ENVIRONMENTAL REVIEW	CLEARED BY ATC <input checked="" type="checkbox"/>	FURTHER REVIEW REQUIRED BY ATC <input type="checkbox"/>				
IS TOWER PAINTED?	YES <input type="checkbox"/>	NO <input checked="" type="checkbox"/>				
IS POST AM STUDY REQUIRED?	YES <input type="checkbox"/>	NO <input type="checkbox"/>				
APPROVAL CONDITIONS:						
CONTINGENCIES:	Engineering Service Required RF Study Required Alltel ROFR Site Pre/Post AM Study May Be Required - Notice To Follow Upon Regulatory Review					
FEASIBILITY SPECIALIST APPROVAL	Shannon Bilderback			DATE	3/10/08	



**AMERICAN TOWER™**  
CORPORATION

3/12/2008

IPCS WIRELESS INC

RE: Colocation Approval & Instruction Letter  
ATC Site Name: MAUMEE RIVER , Ohio  
ATC Site Number: 99044

Dear Customer:

Your application has been preliminarily approved for the colocation of your equipment at American Tower's MAUMEE RIVER , Ohio (99044) tower site. Please review the attached application for any changes or conditions that may vary from your original application. A pre-construction document package on this site is enclosed to assist you with your due diligence.

Please contact your ATC Site Supervisor - Troy Siebenaler at your earliest convenience to schedule a site visit and to discuss the ATC installation process.

Also, please be advised that an Engineering Service is required prior to collocating on this site. American Tower intends to determine the scope and cost of the required Engineering Service shortly. Once you are advised of the cost a PO or check in that amount must be submitted to either your Account Manager or to me in order to avoid unnecessary delays with your application

Additionally, please note that a Shared Site Interference Study (SSIS) is required. American Tower will order the SSIS upon receipt of a Purchase Order for the cost. Please submit a PO as soon as possible.

As part of our ongoing commitment to customer service, please note that we offer A&E services, full service RF study and design, and structural engineering. The Site Supervisor will be able to discuss any of these services with you.

Pursuant to American Tower's Notice to Proceed Process the following documents must be submitted to American Tower:

- Fully executed agreement detailing the proposed installation;
- Proposed Construction Drawings showing the size and location of all improvements or modifications to the site, including all utilities, grounding and back-up power sources. Site Manager will approve the drawings and make any necessary changes to them during the site visit;
- Copy of Building Permit (if applicable) or a letter from the local jurisdiction stating that a Building Permit is not required;
- Contractors Name with a Field and Office Contact Number. Please note that your contractor **MUST** be an ATC approved vendor. In addition, if the contractor sub-contracts the tower climbing work, that sub-contractor must also be an ATC approved vendor. You can speak to the Site Supervisor about this list and how to get your contractor approved.
- Purchase Order for the Site Inspection Fee
- Construction Schedule
- An RF emission analysis demonstrating that the proposed equipment will comply with FCC OET Bulletin 65 and the FCC's rules and will not require an Environmental Assessment;
- If your base station equipment will be installed in an American Tower owned or operated building or shelter, copies of Material Safety Data Sheets (MSDS) for hazardous materials used or stored outside your exclusive building/shelter or equipment cabinet(s) and identified on Hazardous Material Inventory Form (see attached).

Once American Tower has all the necessary aforementioned documents and a pre-construction meeting has occurred with the Site Supervisor, American Tower will issue a "Notice to Proceed" letter.

**CONSTRUCTION MUST NOT BEGIN WITHOUT A FULLY EXECUTED CONTRACT AND A "NOTICE TO PROCEED" LETTER.**

We look forward to having you as our tenant. Please contact me to discuss any questions or comments. Thank you for choosing American Tower Corporation.

Sincerely,

Vinny Paquette  
Assistant Project Manager  
Northeast Area

cc: Susan Ross  
Chuck Griffith

/attachments



THESE DRAWINGS AND/OR THE ADMINISTRATION THEREOF SHALL BE THE PROPERTY OF AMERICAN TOWER. NO PART OF THESE DRAWINGS SHALL BE REPRODUCED, COPIED, REPRODUCED OR TRANSMITTED IN ANY FORM OR BY ANY MEANS, ELECTRONIC OR MECHANICAL, INCLUDING PHOTOCOPYING, RECORDING, OR BY ANY INFORMATION STORAGE AND RETRIEVAL SYSTEM, WITHOUT THE WRITTEN PERMISSION OF AMERICAN TOWER. THESE DRAWINGS SHALL REMAIN THE PROPERTY OF AMERICAN TOWER AND SHALL BE KEPT IN THE OFFICE OF THE LICENSED SURVEYOR. THESE DRAWINGS SHALL BE KEPT IN THE OFFICE OF THE LICENSED SURVEYOR AND SHALL BE AVAILABLE FOR INSPECTION BY THE PUBLIC AT ALL TIMES. THESE DRAWINGS SHALL BE KEPT IN THE OFFICE OF THE LICENSED SURVEYOR AND SHALL BE AVAILABLE FOR INSPECTION BY THE PUBLIC AT ALL TIMES. THESE DRAWINGS SHALL BE KEPT IN THE OFFICE OF THE LICENSED SURVEYOR AND SHALL BE AVAILABLE FOR INSPECTION BY THE PUBLIC AT ALL TIMES.

REV. DESCRIPTION  
ADDRESS

SITE NUMBER:  
99044  
SITE NAME:  
MAJUMEE RIVER  
OHIO

DRAWN BY: E. L. SCHROEDER  
DATE DRAWN: 03/17/2008  
CUSTOMER: IPCS  
COLLOCATION ID: 417027

LEGEND

- ⊗ GROUNDING TEST WELL
- A/C AIR CONDITIONING UNIT
- B BOLLARD
- C CABINET
- E ELECTRIC SERVICE DISC.
- GEN GENERATOR
- G GENERATOR RECEPTACLE
- IB ICE BRIDGE
- M METER RACK
- PP POWER POLE
- T TELEPHONE HOOK-UP
- TRN TRANSFORMER
- W WATER VALVE

DIMENSIONS NOT VERIFIED  
BY LICENSED SURVEYOR

SHEET TITLE: SITE PLAN LAYOUT

SHEET NUMBER: SP-1  
REV. # 0

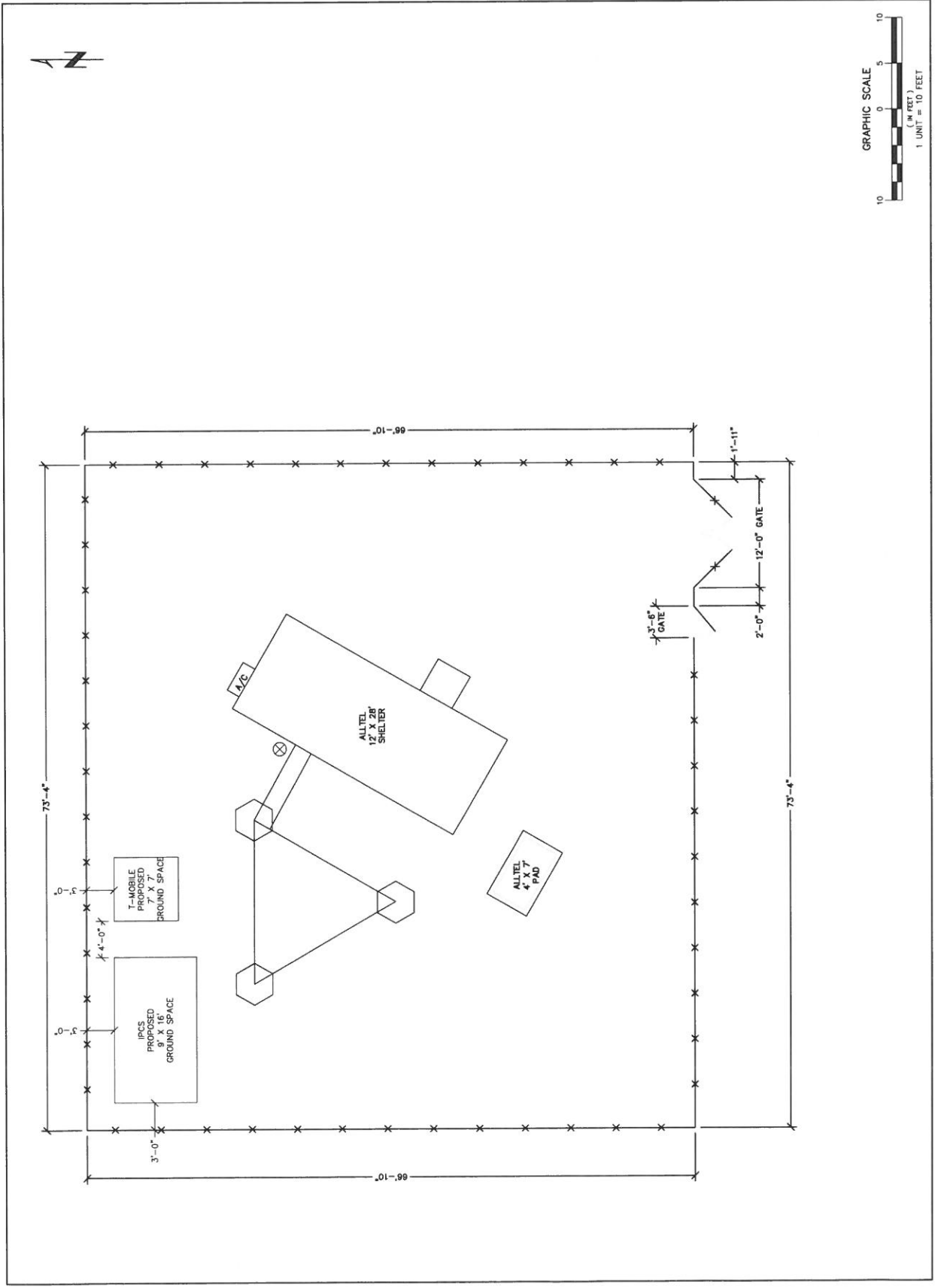

**From :** ["Barbara Tyner" <tyner228@gmail.com>](mailto:tyner228@gmail.com) **Date :** Thu, 17 Apr 2008 11:54:36 -0400  
[+]  
**To :** [astraight@napoleonohio.com](mailto:astraight@napoleonohio.com) [+]  
**Subject :** iPCS Wireless, Inc.

Angela

I work for iPCS Wireless, Inc. We are doing a collocation on a 200' cell tower located at 1515 N. Scott St., Napoleon, Ohio 43545. We are adding six (6) antennas at 170' and an equipment cabinet at the base of the tower (no concrete pad). I need to know if a building permit or any zoning is required for this site. If you have any questions, please give me a call.

Thank you in advance for your help.

--

Barbara J. Tyner  
Site Acquisition Specialist  
Powder River Development  
517-719-9406  
[Tyner228@gmail.com](mailto:Tyner228@gmail.com)